



### SPECIFICATIONS

|                       |                         |
|-----------------------|-------------------------|
| CIRCUIT               | : SPDT                  |
| CURRENT RATING        | : 12mA                  |
| VOLTAGE RATING        | : 24 VDC                |
| TEST VOLTAGE          | : 150V                  |
| CONTACT RESISTANCE    | : 50 mΩ Max (initial)   |
| INSULATION RESISTANCE | : 100 MΩ min.           |
| OPERATING FORCE       | : 170gf ± 50gf          |
| TOTAL TRAVEL          | : 2.5mm ± 0.5mm         |
| OPERATING LIFE        | : 1,000,000 cycles min. |
| SOLDER SPECIFICATION  | : 260°C for 3 seconds   |
| FUNCTION              | : Momentary             |
| OPERATING TEMPERATURE | : -10°C ~ +60°C         |

INDEX

TOGGLE

ROCKER

SLIDE

PUSH BUTTON

DIP

TACT

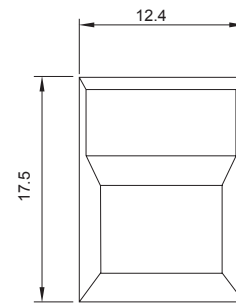
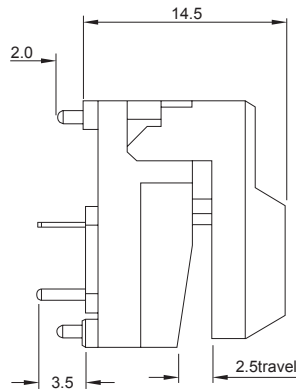
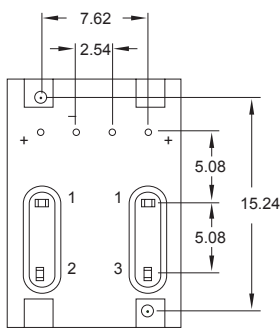

(SP86-A)

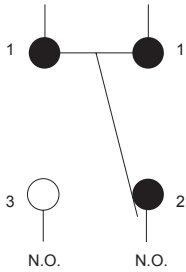

SPDT CONTACT CONFIGURATION

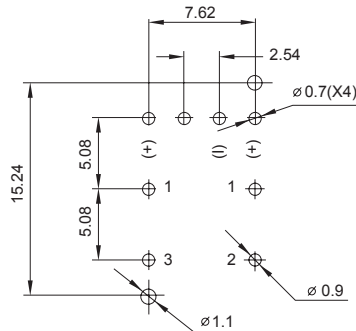

P.C.B. Mounting Holes

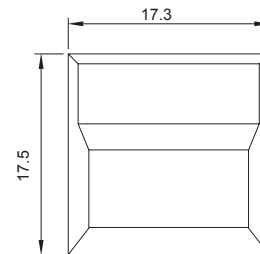

(SP86-B)

### HOW TO ORDER

S P 8 6

CAP STYLES

CAP COLORS

LEFT LED

RIGHT LED

RoHS code

H = RoHS Compliant

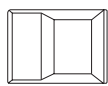
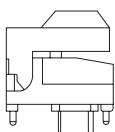

A1



B1

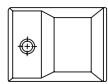

A2



B2

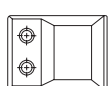

A3



B3

- 1 = RED
- 2 = YELLOW
- 3 = GREEN
- 4 = WHITE
- 5 = BLACK
- 6 = ORANGE
- 7 = BLUE
- 9 = GREY
- 10 = TRANSPARENT

- LED COLORS
- 0 = WITHOUT LED
  - 1 = RED
  - 2 = YELLOW
  - 3 = GREEN
  - 7 = BLUE